



Blue Total Knee System

Features &
System
Specification
Guide



*The Next Generation Total
Knee Replacement*



Features



*Cemented Total
Knee System*



*Cementless Total
Knee System*

Modularity of Implants

The design of Optimotion Blue allows for **modularity and interchangeability** between components.

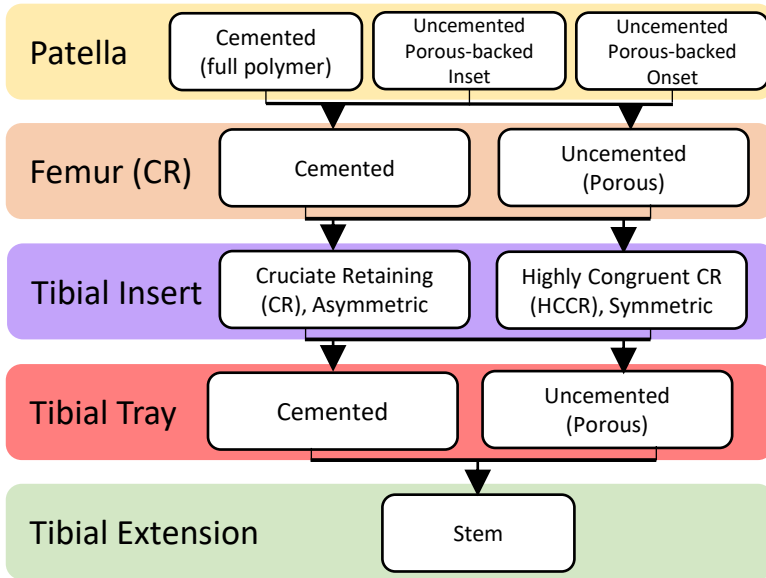

Stemmable Tibial Tray

Optimotion Blue Tibial Trays offer the ability to attach a wide variety of stem sizes (diameter and length) if extra stability is needed. Stems are designed with the capability to be **cemented or cementless**. Stems are attached to the Tibial Tray by a taper connection fastened by a Set Screw.



Advanced Technology

The Porous Components are equipped with **Advanced Porous Additive Manufactured (AM) Technology** to maximize interference coverage on bone contacting surfaces for biological fixation.



The **AM Ultra-Porous Technology** on the Porous Tibial Tray consists of irregularly-shaped random interconnected pores for a three-dimensional porous shape.

The Patella Components and Tibial Inserts are machined to contain **Advanced Polymer Bearing Surface Technology** using compression molded, highly cross-linked, Vitamin-E enhanced, Ultra High Molecular Weight Polyethylene (UHMWPE).

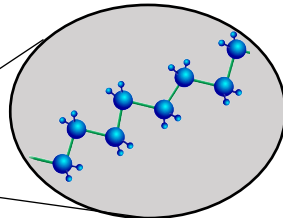

Restore Function *faster*

The Optimotion Blue Total Knee System is optimized for Ambulatory Care Centers due to its innovative instruments that assist with the ***lateral approach***. The lateral approach has been shown to ***reduce hospital stay*** and yield ***superior functional outcomes*** than the traditional anterior approach.¹

MCL Retractors

Our specially designed MCL retractors help to retract and shield the medial collateral ligament while the tibia bone cuts are made during the lateral approach.

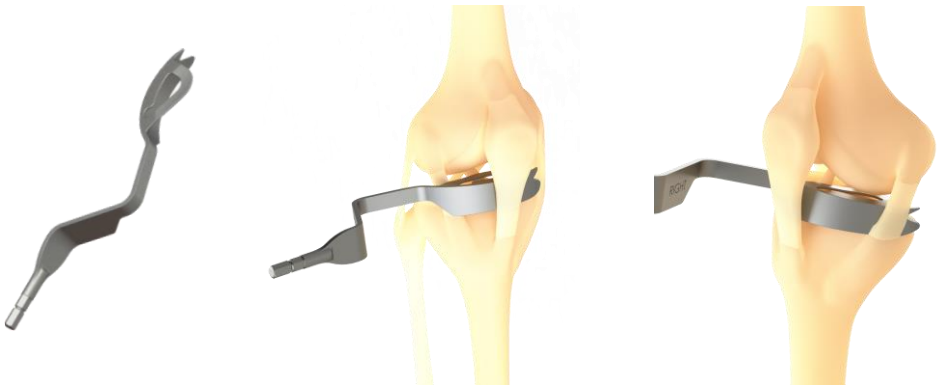

Patient Satisfaction

Patients with Optimotion Blue Total Knee demonstrated ***improved pain, function, and range of motion*** based on 1989 Knee Society Score data collected post-operatively.²

Restore Natural Anatomic Position

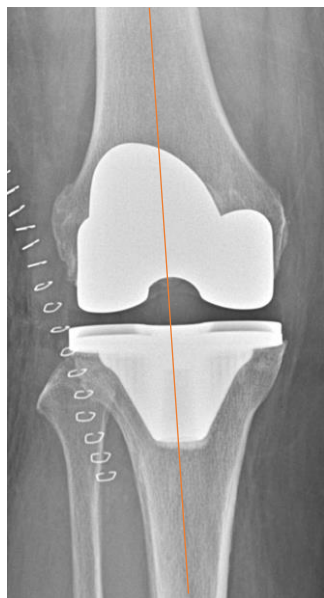



System Specification Guide

Cemented Femoral Component dimensions (mm)
CR, Non-Porous CoCr

Size	Anterior	Posterior
	A	B
1	55.6	59
2	58.3	62
3	60.8	65
4	63.8	68
5	66.4	71
6	69.3	74
7	72.2	77
8	75.3	80

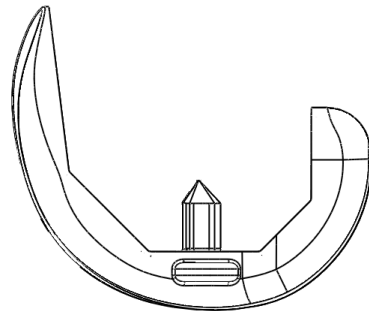
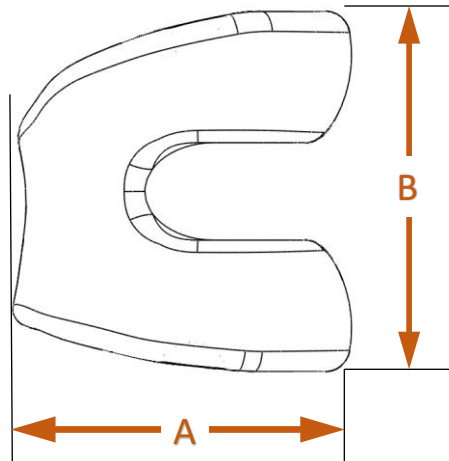

Uncemented Femoral Component dimensions (mm)

CR, Porous CoCr Asymmetric Bead, Cementless

Size	Anterior- Posterior	Medial- Lateral
	A	B
1	55.6	59
2	58.3	62
3	60.8	65
4	63.8	68
5	66.4	71
6	69.3	74
7	72.2	77
8	75.3	80

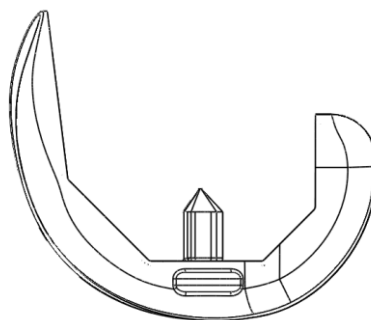
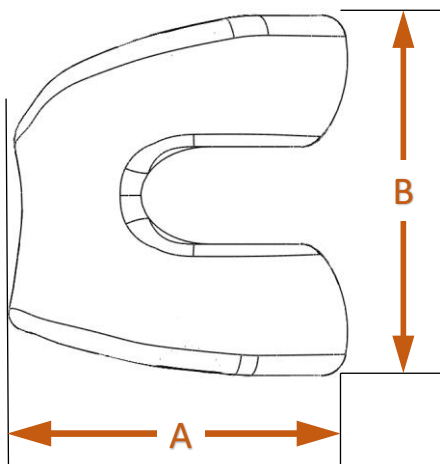

Cemented Tibial Tray dimensions (mm)

Non-Porous Ti

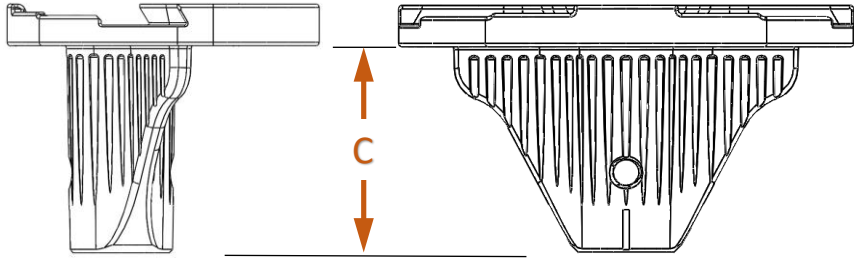

Anterior-
Posterior
Medial-
Lateral
Keel

Size	A	B	C
1	40	61	28.5
2	42.5	64	28.5
3	45	67	28.5
4	47.5	70	31.5
5	50	73	31.5
6	52.5	76	31.5
7	56	81	36.5
8	60	86	36.5

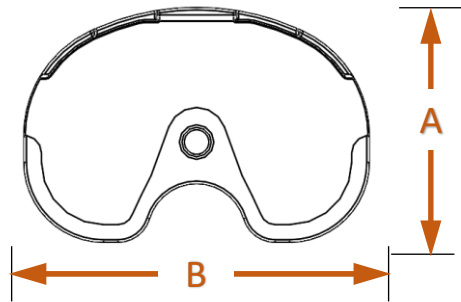

Uncemented Tibial Tray dimensions (mm)

Porous Ti

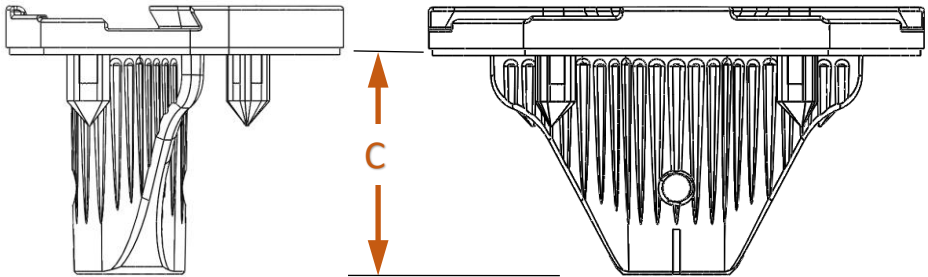

Anterior-
Posterior
Medial-
Lateral
Keel + porous
surface

Size	A	B	C
1	40	61	28.9
2	42.5	64	28.9
3	45	67	28.9
4	47.5	70	31.9
5	50	73	31.9
6	52.5	76	31.9
7	56	81	36.9
8	60	86	36.5

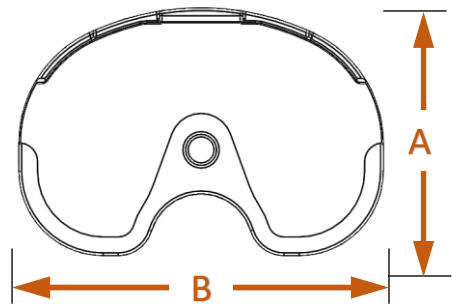

Tibial Stem dimensions (mm)

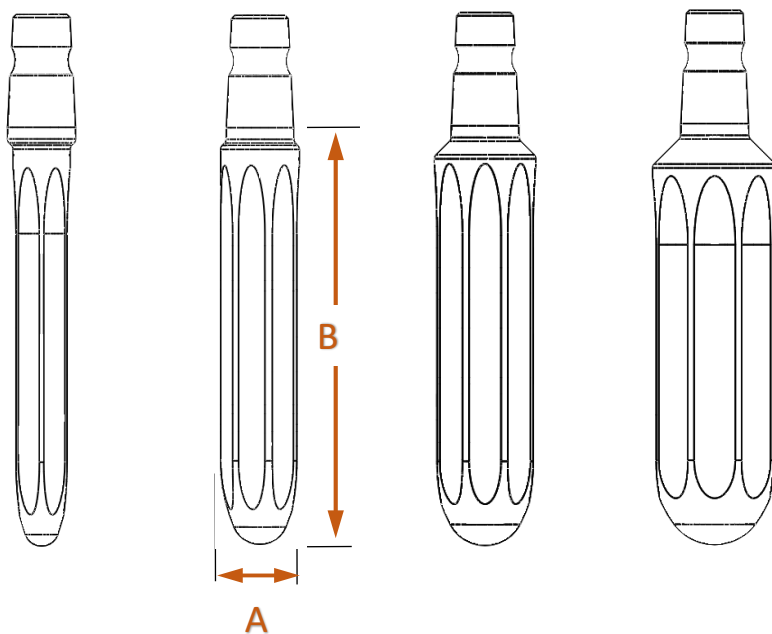

Sizes					
Diameter (A)	Length (B)				
10	150	115	75	50	25
12	150	115	75	50	25
14	150	115	75	50	25
16	150	115	75		
18	150	115	75		
20	150	115	75		
22	150	115	75		

Cemented Patella dimensions (mm)

UHMWPE with Vitamin E

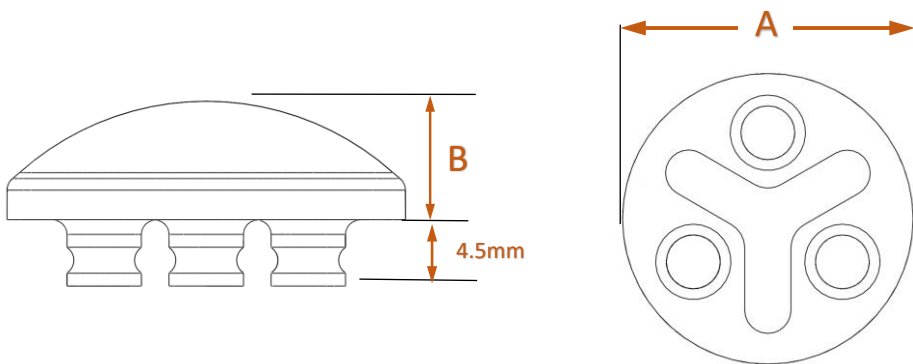

Sizes	
Diameter (A)	Thickness (B)
27	8
29	8
31	9
33	9
36	10
39	11

Onset Uncemented Patella dimensions (mm)

UHMWPE with Vitamin E, Porous Ti

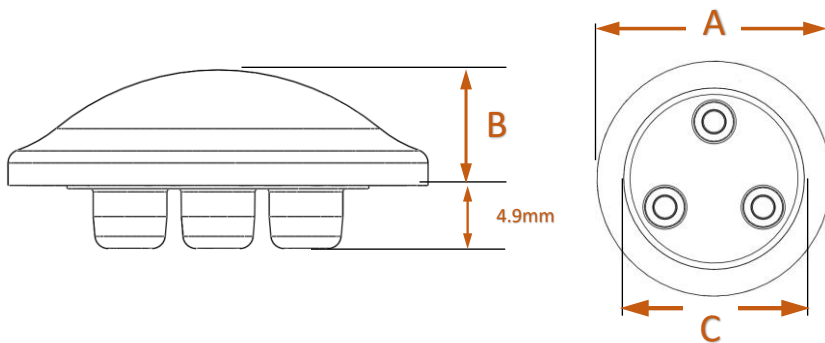

Inset Uncemented Patella dimensions (mm)

UHMWPE with Vitamin E, Porous Ti

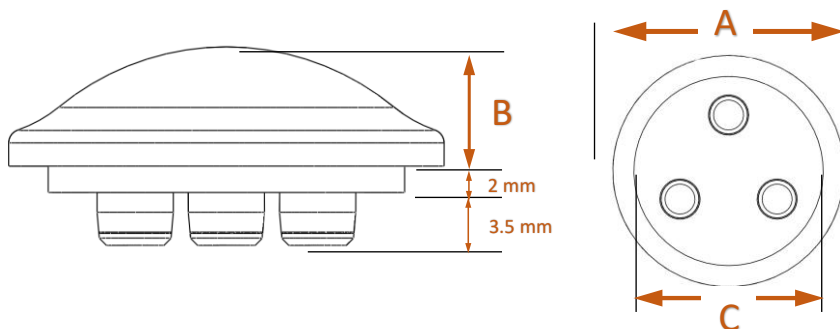

Sizes		Diameter of Metal in Plastic
Diameter A	Thickness B	Dimension C
31	9	25.5
33	9	25.5
36	10	30
39	11	30

CR Tibial Insert dimensions (mm)

UHMWPE with Vitamin E - Asymmetric

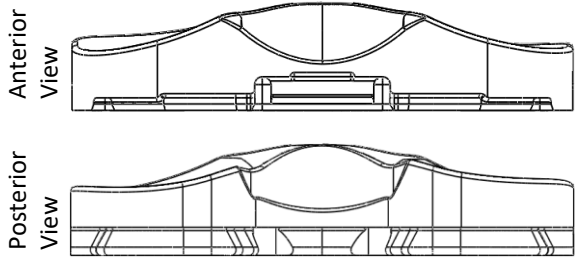

Size	Anterior	Posterior
	A	B
1	40	61
2	42.5	64
3	45	67
4	47.5	70
5	50	73
6	52.5	76
7	56	81
8	60	86

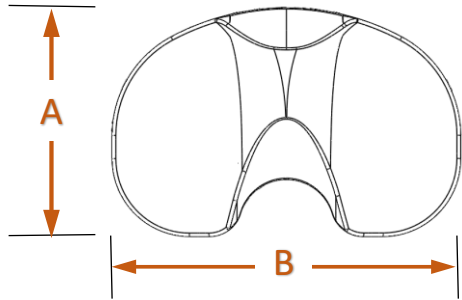

Highly Congruent CR Tibial Insert dimensions (mm)

UHMWPE with Vitamin E

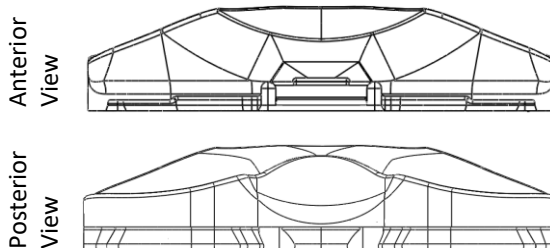

Size	Anterior	Posterior
	A	B
1	40	61
2	42.5	64
3	45	67
4	47.5	70
5	50	73
6	52.5	76
7	56	81
8	60	86

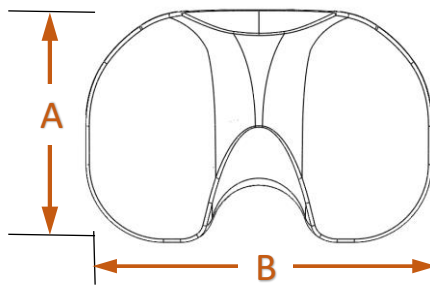























Tibial Inserts *continued*

Insert Thickness selections

Design	Thickness (mm)					
CR	9	11	13	15	17	19
HCCR	9	11	13	15	17	19

Insert Compatibility

		Femoral Size							
		1	2	3	4	5	6	7	8
Insert Size	1								
	2								
	3								
	4								
	5								
	6								
	7								
	8								

*Insert compatibility is the same for all insert and all femur types

Implant Product List

Femurs

CR Femoral Component, Non-Porous, Cemented

Size	Left	Right
1	1014-F-0101	1014-F-0102
2	1014-F-0201	1014-F-0202
3	1014-F-0301	1014-F-0302
4	1014-F-0401	1014-F-0402
5	1014-F-0501	1014-F-0502
6	1014-F-0601	1014-F-0602
7	1014-F-0701	1014-F-0702
8	1014-F-0801	1014-F-0802

CR Femoral Component, Porous CoCr,
Cementless

Size	Left	Right
1	1014-F-4101	1014-F-4102
2	1014-F-4201	1014-F-4202
3	1014-F-4301	1014-F-4302
4	1014-F-4401	1014-F-4402
5	1014-F-4501	1014-F-4502
6	1014-F-4601	1014-F-4602
7	1014-F-4701	1014-F-4702
8	1014-F-4801	1014-F-4802

Tibial Components

Tibial Tray Component, Non-Porous Titanium,
Cemented

Size	Catalog Number
1	1014-B-0100
2	1014-B-0200
3	1014-B-0300
4	1014-B-0400
5	1014-B-0500
6	1014-B-0600
7	1014-B-0700
8	1014-B-0800

Tibial Tray Component, Porous Titanium,
Cementless

Size	Catalog Number
1	1014-B-1100
2	1014-B-1200
3	1014-B-1300
4	1014-B-1400
5	1014-B-1500
6	1014-B-1600
7	1014-B-1700
8	1014-B-1800

Tibial Components *continued*

Tibial Stem

Diameter	Stem Length		
	75mm	50mm	25mm
10mm	1014-S-1005	1014-S-1055	1014-S-1000
12mm	1014-S-1205	1014-S-1255	1014-S-1200
14mm	1014-S-1405	1014-S-1455	1014-S-1400
16mm	1014-S-1605		
18mm	1014-S-1805		
20mm	1014-S-2005		
22mm	1014-S-2205		

Diameter	Stem Length	
	150mm	115mm
10mm	1014-S-1050	1014-S-1015
12mm	1014-S-1250	1014-S-1215
14mm	1014-S-1450	1014-S-1415
16mm	1014-S-1650	1014-S-1615
18mm	1014-S-1850	1014-S-1815
20mm	1014-S-2050	1014-S-2015
22mm	1014-S-2250	1014-S-2215

Taper Set Screw

Size	Catalog Number
One-Size	1014-B-9000

Patella Component

Patella, UHMWPE with Vitamin E, Cemented

Size	Catalog Number
27mm x 8mm	1014-P-2709
29mm x 8mm	1014-P-2908
31mm x 9mm	1014-P-3109
33mm x 9mm	1014-P-3309
36mm x 10mm	1014-P-3610
39mm x 11mm	1014-P-3911

Onset Patella, UHMWPE with Vitamin E, Porous Ti, Cementless

Size	Catalog Number
31mm x 9mm	1014-Q-3109
33mm x 9mm	1014-Q-3309
36mm x 10mm	1014-Q-3610
39mm x 11mm	1014-Q-3911

Inset Patella, UHMWPE with Vitamin E, Porous Ti, Cementless

Size	Catalog Number
31mm x 9mm	1014-R-3109
33mm x 9mm	1014-R-3309
36mm x 10mm	1014-R-3610
39mm x 11mm	1014-R-3911

Tibial Inserts

CR Tibial Insert, UHMWPE + Vitamin E

Thickness	Size 1	
	Left	Right
9mm	1014-P-0109-01	1014-P-0109-02
11mm	1014-P-0111-01	1014-P-0111-02
13mm	1014-P-0113-01	1014-P-0113-02
15mm	1014-P-0115-01	1014-P-0115-02
17mm	1014-P-0117-01	1014-P-0117-02
19mm	1014-P-0119-01	1014-P-0119-02

Thickness	Size 2	
	Left	Right
9mm	1014-P-0209-01	1014-P-0209-02
11mm	1014-P-0211-01	1014-P-0211-02
13mm	1014-P-0213-01	1014-P-0213-02
15mm	1014-P-0215-01	1014-P-0215-02
17mm	1014-P-0217-01	1014-P-0217-02
19mm	1014-P-0219-01	1014-P-0219-02

Thickness	Size 3	
	Left	Right
9mm	1014-P-0309-01	1014-P-0309-02
11mm	1014-P-0311-01	1014-P-0311-02
13mm	1014-P-0313-01	1014-P-0313-02
15mm	1014-P-0315-01	1014-P-0315-02
17mm	1014-P-0317-01	1014-P-0317-02
19mm	1014-P-0319-01	1014-P-0319-02

Thickness	Size 4	
	Left	Right
9mm	1014-P-0409-01	1014-P-0409-02
11mm	1014-P-0411-01	1014-P-0411-02
13mm	1014-P-0413-01	1014-P-0413-02
15mm	1014-P-0415-01	1014-P-0415-02
17mm	1014-P-0417-01	1014-P-0417-02
19mm	1014-P-0419-01	1014-P-0419-02

Thickness	Size 5	
	Left	Right
9mm	1014-P-0509-01	1014-P-0509-02
11mm	1014-P-0511-01	1014-P-0511-02
13mm	1014-P-0513-01	1014-P-0513-02
15mm	1014-P-0515-01	1014-P-0515-02
17mm	1014-P-0517-01	1014-P-0517-02
19mm	1014-P-0519-01	1014-P-0519-02

Thickness	Size 6	
	Left	Right
9mm	1014-P-0609-01	1014-P-0609-02
11mm	1014-P-0611-01	1014-P-0611-02
13mm	1014-P-0613-01	1014-P-0613-02
15mm	1014-P-0615-01	1014-P-0615-02
17mm	1014-P-0617-01	1014-P-0617-02
19mm	1014-P-0619-01	1014-P-0619-02

Thickness	Size 7	
	Left	Right
9mm	1014-P-0709-01	1014-P-0709-02
11mm	1014-P-0711-01	1014-P-0711-02
13mm	1014-P-0713-01	1014-P-0713-02
15mm	1014-P-0715-01	1014-P-0715-02
17mm	1014-P-0717-01	1014-P-0717-02
19mm	1014-P-0719-01	1014-P-0719-02

Thickness	Size 8	
	Left	Right
9mm	1014-P-0809-01	1014-P-0809-02
11mm	1014-P-0811-01	1014-P-0811-02
13mm	1014-P-0813-01	1014-P-0813-02
15mm	1014-P-0815-01	1014-P-0815-02
17mm	1014-P-0817-01	1014-P-0817-02
19mm	1014-P-0819-01	1014-P-0819-02

Tibial Inserts *continued*

Highly Congruent CR Tibial Insert, UHMWPE + Vitamin E

Thickness	Size 1	Size 2
9mm	1014-P-1109	1014-P-1209
11mm	1014-P-1111	1014-P-1211
13mm	1014-P-1113	1014-P-1213
15mm	1014-P-1115	1014-P-1215
17mm	1014-P-1117	1014-P-1217
19mm	1014-P-1119	1014-P-1219

Thickness	Size 3	Size 4
9mm	1014-P-1309	1014-P-1409
11mm	1014-P-1311	1014-P-1411
13mm	1014-P-1313	1014-P-1413
15mm	1014-P-1315	1014-P-1415
17mm	1014-P-1317	1014-P-1417
19mm	1014-P-1319	1014-P-1419

Thickness	Size 5	Size 6
9mm	1014-P-1509	1014-P-1609
11mm	1014-P-1511	1014-P-1611
13mm	1014-P-1513	1014-P-1613
15mm	1014-P-1515	1014-P-1615
17mm	1014-P-1517	1014-P-1617
19mm	1014-P-1519	1014-P-1619

Thickness	Size 7	Size 8
9mm	1014-P-1709	1014-P-1809
11mm	1014-P-1711	1014-P-1811
13mm	1014-P-1713	1014-P-1813
15mm	1014-P-1715	1014-P-1815
17mm	1014-P-1717	1014-P-1817
19mm	1014-P-1719	1014-P-1819

Femoral/Patella Preparation Tray 1

Catalog Number	Description
1014-1-0001	Femoral IM Rod
1014-1-0002	Femoral IM Rod Handle
1014-1-0003	Femoral Angular Alignment Guide
1014-1-0004	Distal Femoral Alignment Guide
1014-1-0005	Distal Femoral Cut Block
1014-1-0048	Femoral Drill
1014-1-0052	Femoral Driver
1014-1-0056	Angel Wing
1014-1-0057	Femoral Sizer 2.0
1014-2-0025	Z-Retractor
1014-2-0032	MCL Retractor, Left
1014-2-0033	MCL Retractor, Right
1014-2-0034	Impactor Handle
1014-3-0009	Patella Stylus 9mm
1014-3-0010	Patella Stylus 10mm
1014-3-0012	Patella Resection Guide, Left
1014-3-0013	Patella Resection Guide, Right
1014-3-0014	Patella Drill
1014-3-0015	Patella Drill Guide
1014-3-0016	Patella Cement Clamp-Anterior Side
1014-3-0017	Patella Cement Clamp-Posterior Side
1014-3-0019	Patella Resection Clamp
1014-3-0033	Patella Sizer 33MM
1014-3-0036	Patella Sizer 36MM
1014-3-0039	Patella Sizer 39MM
1014-3-2708	Patella Trial 27MM x 8MM
1014-3-2908	Patella Trial 29MM x 8MM
1014-3-3109	Patella Trial 31MM x 9MM
1014-3-3309	Patella Trial 33MM x 9MM
1014-3-3610	Patella Trial 36MM x 10MM
1014-3-3911	Patella Trial 39MM x 11MM
1014-3-1000	Reamer Guide, Porous Patella
1014-3-1001	Drill Guide, Porous Patella
1014-3-1002	Reamer, Porous Patella

Tibial Preparation Tray 2

Catalog Number	Description
1014-1-0055	Pin Puller
1014-1-0061	Curved Osteotome
1014-2-0002	Tibial Resection Guide
1014-2-0004	Tibial Stylus 4 & 9MM
1014-2-0005	Tibial Tray Template Handle
1014-2-0007	Tibial Tray Central Drill 16MM
1014-2-0008	Tibial Stylus 2 & 11MM
1014-2-0009	Tibial Tray Central Drill 17MM
1014-2-0010	Auxillary Peg Punch Short
1014-2-0011	EM Guide-Resection Guide Connector 3 -degree
1014-2-0012	EM Guide-Resection Guide Connector 0-degree
1014-2-0031	Tibial Tray Impactor
1014-2-0017	Tibial Insert Impactor
1014-2-0022	3.5MM Hex Driver
1014-2-0029	Dynamic Gap Balancing Gage
1014-2-0030	EM Guide Assembly
1014-2-0035	2.5MM Hex Driver
1014-2-0013	Tibial Keel Punch Guide Size 1-3
1014-2-1456	Tibial Keel Punch Guide Size 4-6
1014-2-1078	Tibial Keel Punch Guide Size 7-8
1014-2-2123	Tibial Keel Punch Size 1-3
1014-2-2456	Tibial Keel Punch Size 4-6
1014-2-2078	Tibial Keel Punch Size 7-8
1014-2-3001	Tibial Tray Template Size 1
1014-2-3002	Tibial Tray Template Size 2
1014-2-3003	Tibial Tray Template Size 3
1014-2-3004	Tibial Tray Template Size 4
1014-2-3005	Tibial Tray Template Size 5
1014-2-3006	Tibial Tray Template Size 6
1014-2-3007	Tibial Tray Template Size 7
1014-2-3008	Tibial Tray Template Size 8

Femoral Trialing Tray 3

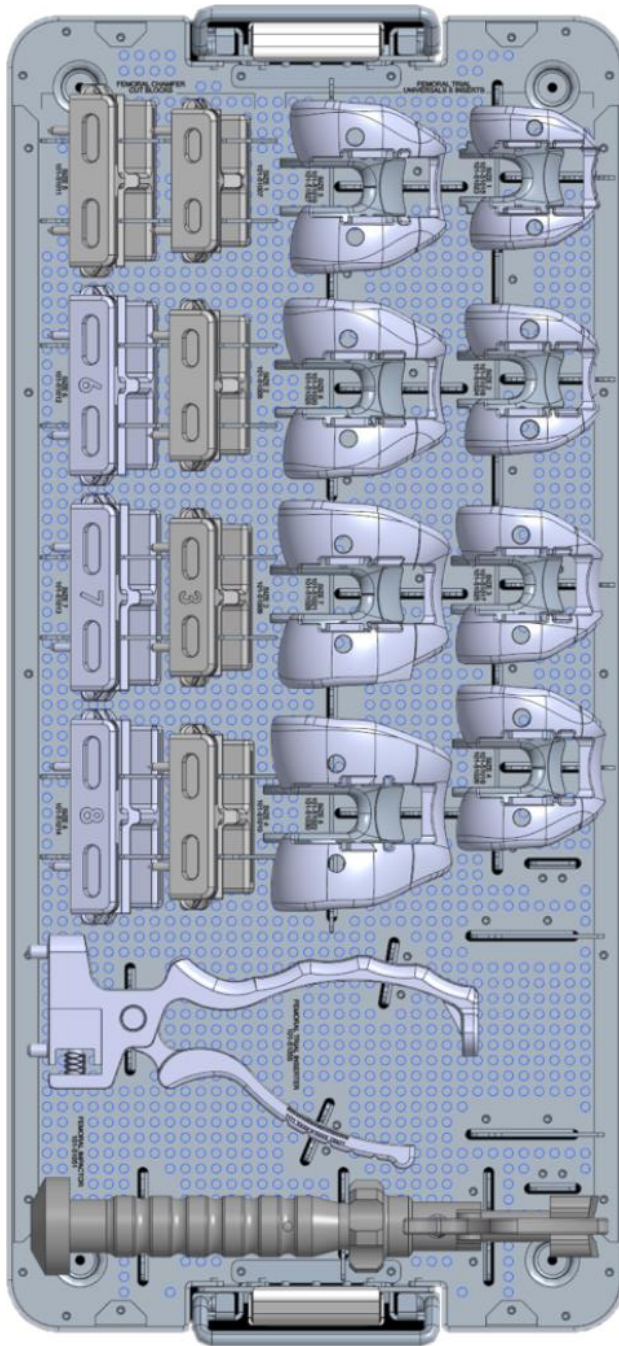

Femoral Trialing Tray 3

Catalog Number	Description
1014-1-0051	Femoral Impactor
1014-1-0053	3.2MM Fluted Pin
1014-1-0058	Femoral Trial Insert
1014-1-1001	Femoral Chamfer Cut Block Size 1
1014-1-1002	Femoral Chamfer Cut Block Size 2
1014-1-1003	Femoral Chamfer Cut Block Size 3
1014-1-1004	Femoral Chamfer Cut Block Size 4
1014-1-1005	Femoral Chamfer Cut Block Size 5
1014-1-1006	Femoral Chamfer Cut Block Size 6
1014-1-1007	Femoral Chamfer Cut Block Size 7
1014-1-1008	Femoral Chamfer Cut Block Size 8
1014-1-2001	Femoral Trial Universal Size 1
1014-1-2002	Femoral Trial Universal Size 2
1014-1-2003	Femoral Trial Universal Size 3
1014-1-2004	Femoral Trial Universal Size 4
1014-1-2005	Femoral Trial Universal Size 5
1014-1-2006	Femoral Trial Universal Size 6
1014-1-2007	Femoral Trial Universal Size 7
1014-1-2008	Femoral Trial Universal Size 8
1014-1-2101	Femoral Trial Insert CR Size 1
1014-1-2102	Femoral Trial Insert CR Size 2
1014-1-2103	Femoral Trial Insert CR Size 3
1014-1-2104	Femoral Trial Insert CR Size 4
1014-1-2105	Femoral Trial Insert CR Size 5
1014-1-2106	Femoral Trial Insert CR Size 6
1014-1-2107	Femoral Trial Insert CR Size 7
1014-1-2108	Femoral Trial Insert CR Size 8
1014-2-0006	3.2MM Headed Pins

Tibial Trialing Tray 4

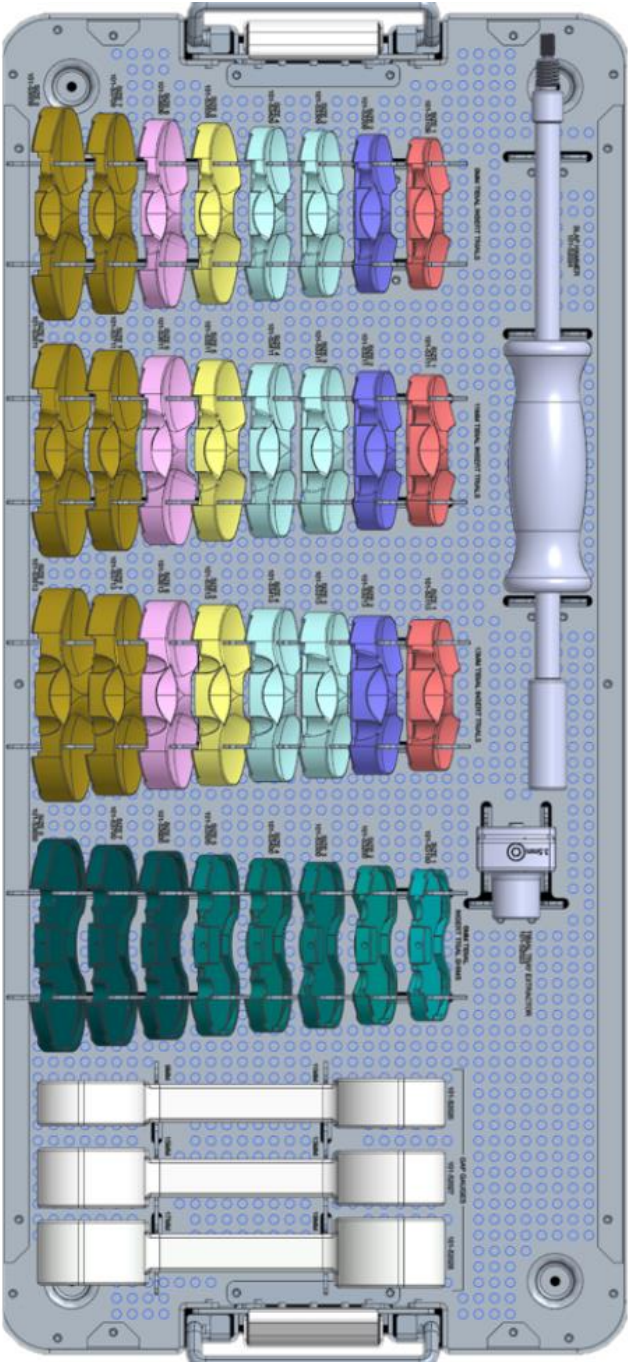

Tibial Trialing Tray 4

Catalog Number	Description
1014-2-0023	Tibial Tray Extractor
1014-2-0024	Slap Hammer
1014-2-0911	Gap Gage 9MM & 11MM
1014-2-1315	Gap Gage 13MM & 15MM
1014-2-1719	Gap Gage 17MM & 19MM
1014-4-0061	Tibial Insert Trial 6MM SHIM Size 1
1014-4-1009	Tibial Insert Trial CR Universal-Size 1, 9MM
1014-4-1011	Tibial Insert Trial CR Universal-Size 1, 11MM
1014-4-1013	Tibial Insert Trial CR Universal-Size 1, 13MM
1014-4-0062	Tibial Insert Trial 6MM SHIM Size 2
1014-4-2009	Tibial Insert Trial CR Universal-Size 2, 9MM
1014-4-2011	Tibial Insert Trial CR Universal-Size 2, 11MM
1014-4-2013	Tibial Insert Trial CR Universal-Size 2, 13MM
1014-4-0063	Tibial Insert Trial 6MM SHIM Size 3
1014-4-3009	Tibial Insert Trial CR Universal-Size 3, 9MM
1014-4-3011	Tibial Insert Trial CR Universal-Size 3, 11MM
1014-4-3013	Tibial Insert Trial CR Universal-Size 3, 13MM
1014-4-0064	Tibial Insert Trial 6MM SHIM Size 4
1014-4-4009	Tibial Insert Trial CR Universal-Size 4, 9MM
1014-4-4011	Tibial Insert Trial CR Universal-Size 4, 11MM
1014-4-4013	Tibial Insert Trial CR Universal-Size 4, 13MM
1014-4-0065	Tibial Insert Trial 6MM SHIM Size 5
1014-4-5009	Tibial Insert Trial CR Universal-Size 5, 9MM
1014-4-5011	Tibial Insert Trial CR Universal-Size 5, 11MM
1014-4-5013	Tibial Insert Trial CR Universal-Size 5, 13MM
1014-4-0066	Tibial Insert Trial 6MM SHIM Size 6
1014-4-6009	Tibial Insert Trial CR Universal-Size 6, 9MM
1014-4-6011	Tibial Insert Trial CR Universal-Size 6, 11MM
1014-4-6013	Tibial Insert Trial CR Universal-Size 6, 13MM

Tibial Trialing Tray 4 *continued*

Catalog Number	Description
1014-4-0067	Tibial Insert Trial 6MM SHIM Size 7
1014-4-7009	Tibial Insert Trial CR Universal-Size 7, 9MM
1014-4-7011	Tibial Insert Trial CR Universal-Size 7, 11MM
1014-4-7013	Tibial Insert Trial CR Universal-Size 7, 13MM
1014-4-0068	Tibial Insert Trial 6MM SHIM Size 8
1014-4-8009	Tibial Insert Trial CR Universal-Size 8, 9MM
1014-4-8011	Tibial Insert Trial CR Universal-Size 8, 11MM
1014-4-8013	Tibial Insert Trial CR Universal-Size 8, 13MM

Optimotion Implants™



For detailed product information, including indications for use, contraindications, precautions and warnings, please consult the product's System Instructions for Use, Instrument Instructions for Use, and Surgical Technique Guide found at www.optimotionimplants.com.

Optimotion Implants, LLC.

6052 Turkey Lake Rd
Suite 170
Orlando, FL 32819

www.optimotionimplants.com



References

1. Nguyen, S., & Rogan, A. (2019, January). *A Lateral Subvastus Approach to Total Knee Arthroplasty: Short-term Safety and Efficacy*. Poster presented at the Orthopaedics Today Meeting, Hawaii.
2. Nguyen, S., & Rogan, A. (2020). [Knee Society Scores obtained from patients of Optimotion Orthopaedics who have undergone total knee arthroplasty with Optimotion Implants Blue Total Knee System]. Unpublished raw data.